

BEVERAGE COOLER

Instruction Manual



❖ **ALT-B00-1-BL**

❖ **ALT-B00-2-BL**

❖ **ALT-B00-3-BL**

SAFETY TIPS

- Position on a flat, stable surface.
- A service agent/qualified technician should carry out installation and any repairs if required. Do not remove any components or service panels on this product.
- Consult Local and National Standards to comply with the following:
 - Health and Safety at Work Legislation
 - EN Codes of Practice
 - Fire Precautions
 - IEE Wiring Regulations
 - Building Regulations
- DO NOT immerse in water, or use steam/jet washers to clean the unit.
- DO NOT cover the appliance when it is operating.
- DO NOT store food in the appliance.
- DO NOT use electrical appliances inside the appliance.
- Always carry, store and handle the appliance in a vertical position.
- Never tilt the appliance more than 45° from the vertical.
- Not suitable for outdoor use.
- Keep all packaging away from children. Dispose of the packaging in accordance with the regulations of local authorities.
- If the power cord is damaged, it must be replaced by an agent or an recommended qualified technician in order to avoid hazard and accident.
- This appliance is not intended for use by persons (including children) with reduced physical, sensory or mental capabilities, or lack of experience and knowledge, unless they have been given supervision or instruction concerning the use of the appliance by a person responsible for their safety.

- Children should be supervised to ensure that they do not play with the appliance.
- Recommend that this appliance is PAT tested on an annual basis to ensure the product remains safe.



Caution Risk of Fire

- Do not store explosive substances such as aerosol cans with a flammable propellant in this appliance.



Warning: Keep all ventilation openings clear of obstruction. Unit should not be boxed in without adequate ventilation.

- **Warning:** Do not use mechanical devices or other means to accelerate the defrosting process, other than those recommended by the manufacturer.
- **Warning:** Do not damage the refrigerant circuit.
- **Warning:** Do not use electrical appliances inside the food storage compartments of the appliance, unless they are the type recommended by the manufacturer.

Introduction

Please take a few moments to carefully read through this manual. Correct maintenance and operation of this machine will provide the best possible performance from your product.

PACK CONTENT

ALL MODELS:

- Bar Back Chiller
- Key
- Instruction Manual

Plus...

- 1 DOOR Model: 2 Adjustable Shelves
- 2 DOOR Model: 4 Adjustable Shelves
- 3 DOOR Model: 6 Adjustable Shelves

Pride itself on quality and service, ensuring that at the time of packaging the contents are supplied fully functional and free of damage.

Should you find any damage as a result of transit, please contact your dealer immediately.

INSTALLATION

1. Removed the appliance from the packaging and the protective film from all surfaces.
2. Avoid positioning the appliance in direct sunlight or damp areas.
3. Maintain a distance of 20cm (7inches) between the unit and walls or other objects of ventilation.

NEVER LOCATE NEXT TO OR NEAR HEAT SURFACES.

4. Insert the slide-out shelf/shelves at the desired levels.
5. If necessary adjust the screw feet of the appliance to make it level.



Note: Before using the appliance for the first time, clean the shelf/shelves with soapy water

OPERATION

CONTROL PANEL

The control panel is located below the doors on front of the appliances

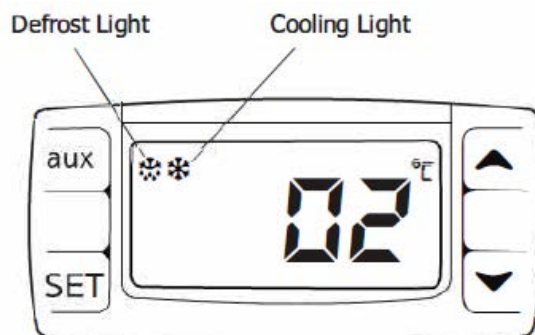

TURN ON

1. Choose the door (s) of the appliance
2. Connect the appliance to main power supply.



Note: The cooling light is illuminated when the appliance is chilling the interior cabinet.

To Change the operating Temperature

The default operating temperature 2°C to display the operating temperature (set point) press and release immediately the button

To change the operating temperature:

1. Press and hold the SET button for 2secs the "C" will start to flash.
2. Press the ▲ or ▼ buttons to change the temperature.
3. Press the SET button to store the temperature.

Manual Defrost

- Back Bar Chillers feature an automatic defrost. However, should the appliance require an additional defrost period press and hold the  button for 2 seconds.
- Automatic defrost cycles are every 6 hours and last 20 minutes (factory defaults).



Note: If a manual defrost is started this resets the automatic defrost timer. During defrost periods the Defrost light is illuminated.

Cleaning, Care & Maintenance

- Switch off and disconnect from the power supply before cleaning.
- Clean the interior of the appliance as often as possible.
- Do not use abrasive cleaning agents. These can leave harmful residues.
- Always wipe dry after cleaning.
- A agent or qualified technician must carry out repairs if required.

Cleaning the Condenser

Periodically cleaning the condenser can extend the life of the appliance. The condenser is located at the back of the appliance.



Note: Use a soft brush or vacuum cleaner to clean the fins of the condenser, taking care not to damage the fins.

Replacing the Interior Lamp



WARNING: Allow the lamp to cool before replacing. The lamp remains hot immediately after use.

1. Turn Off and disconnect the appliance from the mains power supply.
2. Unplug the lamp from the socket.
3. Insert the new lamp into place.

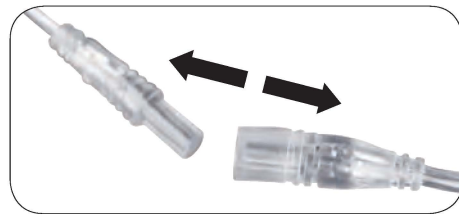

Troubleshooting

If your appliance develops a fault, please check the following table before making a call to the Helpline.

Fault	Probable Cause	Solution
The appliance is not working	The unit is not switched on	Check the unit is plugged in correctly and switched on
	Plug and lead are damaged	Call agent or qualified Technician
	Fuse in the plug has blown	Replace the fuse
	Power supply	Check power supply
	Internal wiring fault	Call agent or qualified Technician
The appliance turns on, but the temperature is too high/low	Condenser blocked with dust	Clean Condenser
	Doors are not shut properly	Check doors are shut and seals are not damaged

Fault	Probable Cause	Solution
The appliance turns on, but the temperature is too high/low	Appliance is located near a heat source or air flow to the condenser is being interrupted	Move the appliance to a more suitable location
	Ambient temperature is too high	Increase ventilation or move appliance to a cooler position
	Insufficient airflow to the fans	Remove any blockages to the fans
	Appliance is overloaded	Reduce the amount stored in the appliance
	Factory default parameters adjusted	Call agent or qualified Technician
The appliance is unusually loud	The appliance is touching a neighbouring object	Check installation position and change if necessary
	The appliance has not been installed in a level or stable position	Check installation position and change if necessary

Electrical Wiring

The plug is to be connected to a suitable mains socket.

Appliances are wired as follows:

- Live wire (coloured brown) to terminal marked L
- Neutral wire (coloured blue) to terminal marked N
- Earth wire (coloured green/yellow) to terminal marked E

This appliance must be earthed.



If in doubt consult a qualified electrician.

Electrical isolation points must be kept clear of any obstructions. In the event of any emergency disconnection being required they must be readily accessible.

Disposal

EU regulations require refrigeration product to be disposed of by specialist companies who remove or recycle all gasses, metal and plastic components.

Consult your local waste collection authority regarding disposal of your appliance. Local authorities are not obliged to dispose of commercial refrigeration equipment but may be able to offer advice on how to dispose of the equipment locally.

Alternatively call the helpline for details of national disposal companies within the EU.

Compliance

The WEEE logo on this product or its documentation indicates that the product must not be disposed of as household waste. To help prevent possible harm to human health and/or the environment, the product must be disposed of in an approved and environmentally safe recycling process. For further information on how to dispose of this product correctly, contact the product supplier, or the local authority responsible for waste disposal in your area.



Parts have undergone strict product testing in order to comply with regulatory standards and specifications set by international, independent, and federal authorities.



Products have been approved to carry the following symbol:

ALT-BOO-1-BL

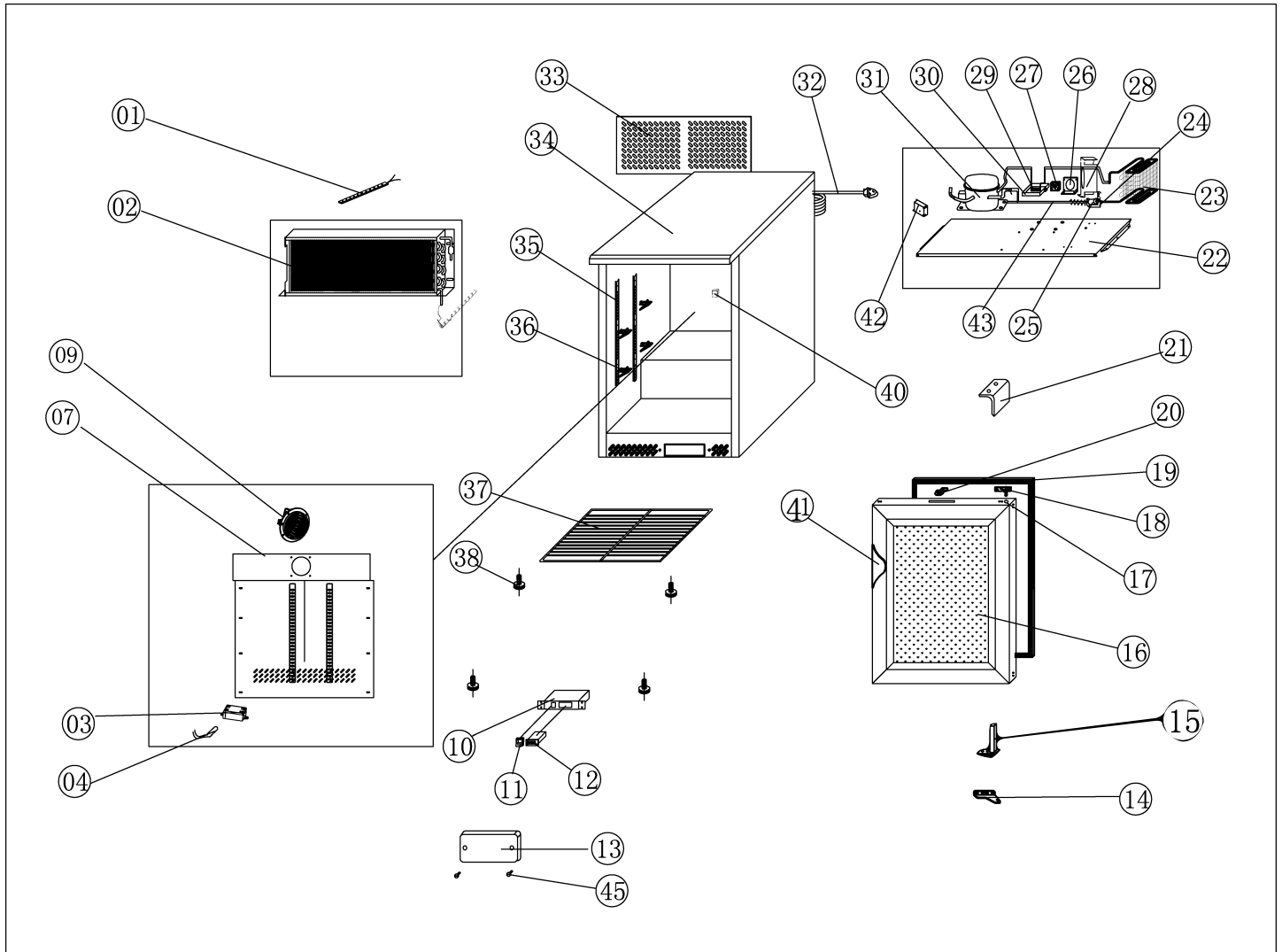

NO.	PART NAME	QTY.
1	LED LAMP	1PC
2	EVAPORATOR	1PC
3	SENSOR FIXED BOX	1PC
4	SENSOR	2PCS
7	CIRCUIT FAN SUPPORT 1	1PC
9	CIRCUIT FAN	1PC
10	THERMOSTAT BOX	1PC
11	MAIN SWITCH	1PC
12	THERMOSTAT	1PC
13	THERMOSTAT COVER	1PC
14	DOWN HINGE RIGHT	1PC
15	DOOR SPRING	1PC
16	GLASS DOOR	1PC
17	HINGE AXIS BUSHING	1PC
18	UP HINGE RIGHT	1PCS
19	DOOR SEAL	1PC
20	LOCK & KEY	1PC
21	LOCK HOOK	1PC
22	UNIT BOARD	1PC
23	CONDENSER	1PC

NO.	PART NAME	QTY.
24	DRIER SUPPORT	1PC
25	FILTER DRIER	1PC
26	CONDENSER FAN SUPPORT	1PC
27	CONDENSER FAN	1PC
28	CONDENSER FAN BOARD	1PC
29	DISCHARGE PIPE	1PC
30	WATER BOX	1PC
31	COMPRESSOR (R134A)	1PC
32	PLUG	1PC
33	UNIT ROOM COVER	1PC
34	BODY	1PC
35	SHELF SUPPORT	4PCS
36	SHELF CLIP	8PCS
37	SHELF	2PCS
38	FEET	4PCS
40	LIGHT SWITCH	1PC
41	HANDLE	1PC
42	LED TRANSFORMER	1PC
43	SUCTION PIPE	1PC
45	BOLT	2PCS

ALT-BOO-2-BL

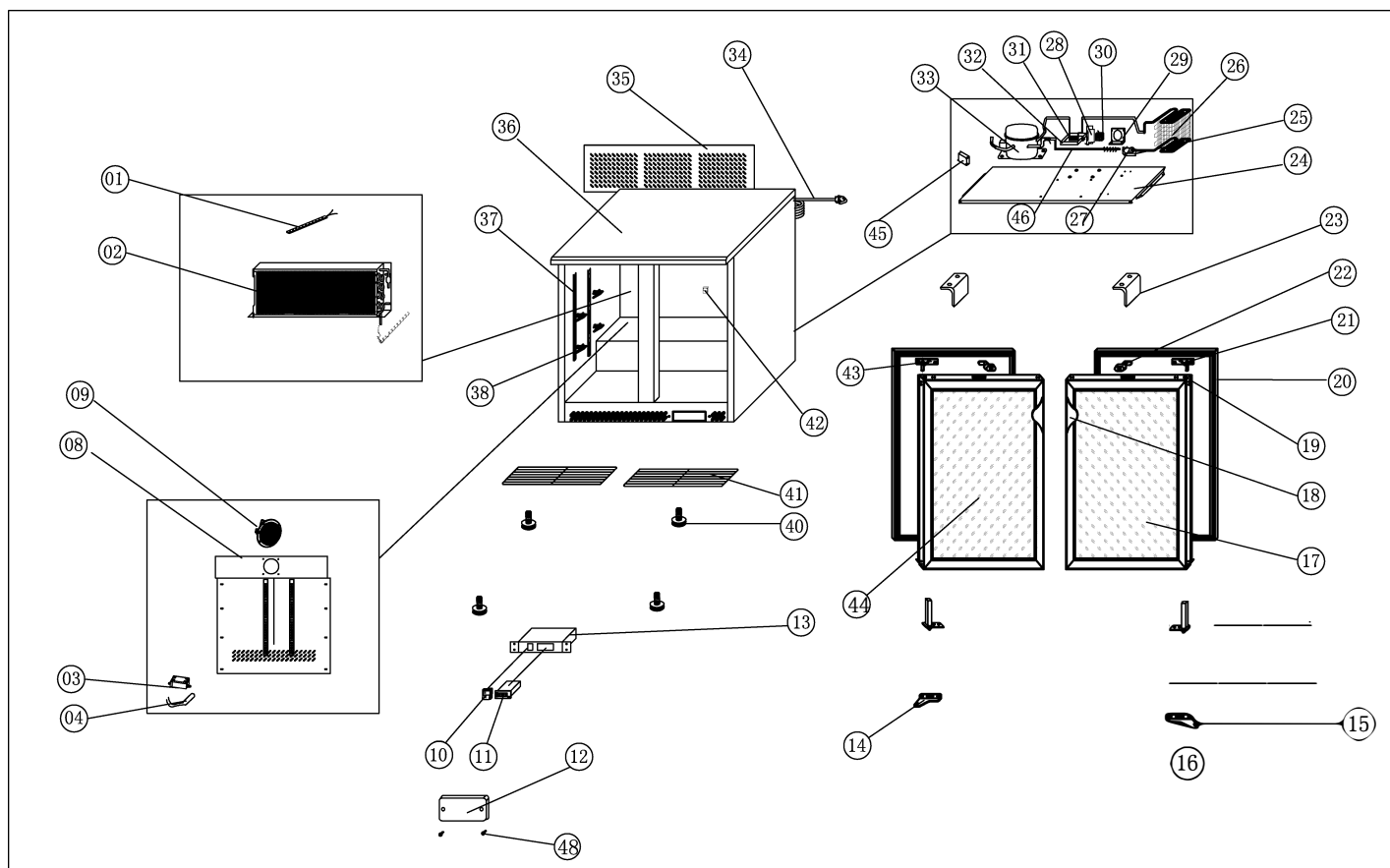

NO.	PARTNAME	QTY.
1	LED LAMP	1PC
2	EVAPORATOR	1PC
3	SENSOR FIXED BOX	1PC
4	SENSOR	2PCS
8	CIRCUIT FAN SUPPORT 2	1PC
9	CIRCUIT FAN	1PC
10	MAIN SWITCH	1PC
11	THERMOSTAT	1PC
12	THERMOSTAT COVER	1PC
13	THERMOSTAT BOX	1PC
14	DOWN HINGE LEFT	1PC
15	DOWN HINGE RIGHT	1PC
16	DOOR SPRING	1PC
17	GLASS DOOR RIGHT	1PC
18	HANDLE	2PCS
19	HINGE AXIS BUSHING	2PCS
20	DOOR SEAL	2PCS
21	UP HINGE RIGHT	1PCS
22	LOCK & KEY	2PCS
23	LOCK HOOK	2PCS
24	UNIT BOARD	1PC

NO.	PARTNAME	QTY.
25	DRIER SUPPORT	1PC
26	CONDENSER	1PC
27	FILTER DRIER	1PC
28	CONDENSER FAN BOARD	1PC
29	CONDENSER FAN SUPPORT	1PC
30	CONDENSER FAN	1PC
31	DISCHARGE PIPE	1PC
32	WATER BOX	1PC
33	COMPRESSOR (R134A)	1PC
34	PLUG	1PC
35	UNIT ROOM COVER	1PC
36	BODY	1PC
37	SHELF SUPPORT	8PCS
38	SHELF CLIP	16PCS
40	FEET	4PCS
41	SHELF	4PCS
42	LIGHT SWITCH	1PC
43	UP HINGE LEFT	1PC
44	GLASS DOOR LEFT	1PC
45	LED TRANSFORMER	1PC
46	SUCTION PIPE	1PC

ALT-B00-3-BL

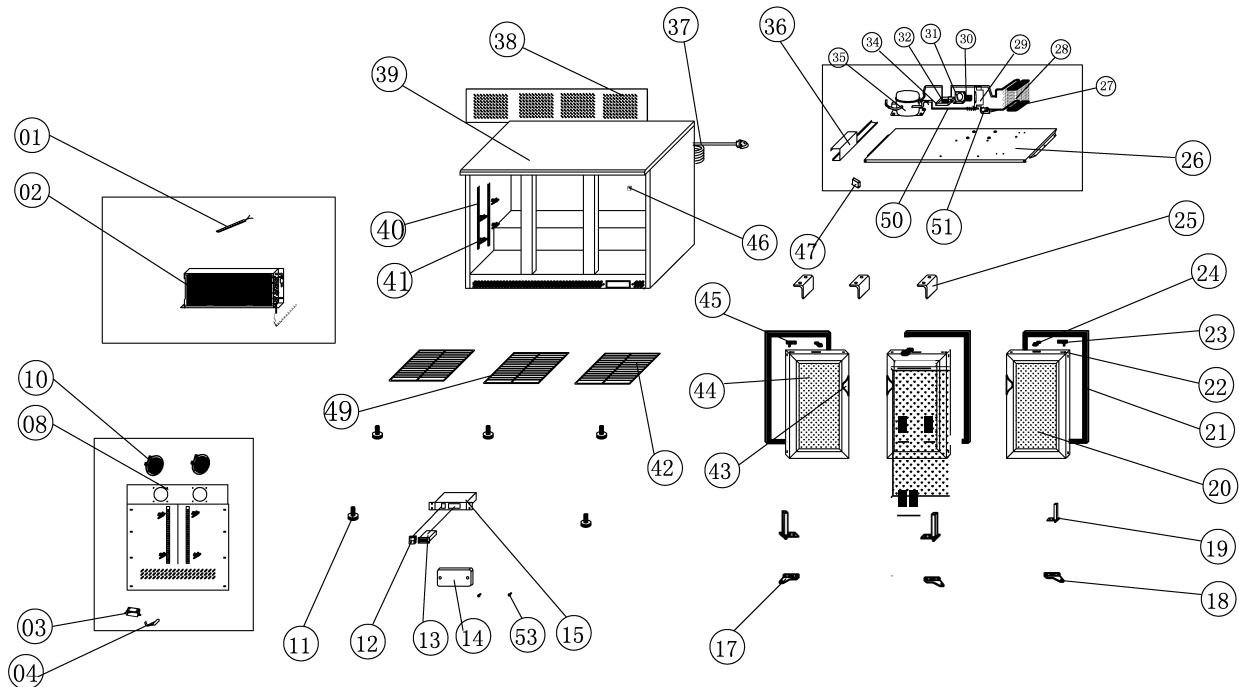

NO.	PART NAME	QTY.
1	LED LAMP	1PC
2	EVAPORATOR	1PC
3	SENSOR FIXED BOX	1PC
4	SENSOR	1PC
4	SENSOR	1PC
8	CIRCUIT FAN SUPPORT 2	1PC
10	CIRCUIT FAN	2PCS
11	FEET	5PCS
12	MAIN SWITCH	1PC
13	THERMOSTAT	1PC
14	THERMOSTAT COVER	1PC
15	THERMOSTAT BOX	1PC
17	DOOR HINGE LEFT	1PC
18	DOOR HINGE RIGHT	2PCS
19	DOOR SPRING	3PCS
20	RIGHT GLASS DOOR	2PCS
21	GASKET	3PCS
22	HINGE AXIS BUSHING	3PCS
23	UP HINGE RIGHT	2PCS
24	LOCK	3PCS
25	LOOK HOOK	3PCS
26	UNIT BOARD	1PC
27	DRIER SUPPORT	1PC
28	CONDENSER	1PC

NO.	PART NAME	QTY.
29	CONDENSER FAN SUPPORT	1PC
30	CONDENSER FAN	1PC
31	CONDENSER FAN FIXED SUPPORT	1PC
32	DISCHARGE PIPE	1PC
34	WATER BOX	1PC
35	COMPRESSOR(R600A)	1PC
36	UNIT BOARD SUPPORT	1PC
37	PLUG	1PC
38	UNIT ROOM COVER	1PC
39	BODY	1PC
40	SHELF SUPPORT	12PCS
41	SHELF CLIP	24PCS
42	SHELF	4PCS
43	HANDLE	3PCS
44	LEFT GLASS DOOR	1PC
45	UP HINGE LEFT	1PC
46	LIGHT SWITCH	1PC
47	TRANSFORMER FOR LED LAMP	1PC
49	SHELF	2PCS
50	SUCTION PIPE	1PC
51	FILTER DRIER	1PC
53	BOLT	2PCS